

Hydraulink[®]

Hose and Fittings



Section 13

Tube Clamps

GENERAL INFORMATION

The Hydraulink range of tube clamps is available in four main series. For normal mechanical stress applications (up to approximately 200bar line pressure), clamps are available either as single or twin. For high mechanical stress applications (high pressure, flow or impulse) clamps are available either as single heavy duty or extra heavy duty.

For all series the clamp halves are identical and incorporate either a knurled or ribbed bore to absorb impact and vibration as well as provide high shear strength in the direction of the tube axis. Clamp halves are typically supplied in polypropylene, but are also available in fire-resistant polyamide or aluminium on request.

Clamp bolts, top plates and base plates are typically supplied in steel and finished with a silver trivalent chromium plating and clear sealant to further increase protection against corrosion, but are also available in AISI 316 stainless steel. Please contact Hydraulink for further details regarding alternative mounting systems such as stacking bolts, multiple clamp base plates and track rails.

All four series of tube clamp supplied by Hydraulink can be supplied in metric or imperial tube sizes (true O.D.) or to suit schedule 40, 80 or 160 pipe (nominal bore).

Hydraulink Australia Pty Ltd, reserves the right to discontinue, or to alter the design and specification of any product listed in this catalogue.

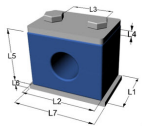
SINGLE TUBE CLAMPS

SINGLE TUBE CLAMPS
CS-C
 Page 13 - 5

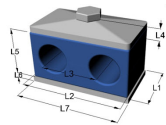
DOUBLE TUBE CLAMPS

DOUBLE TUBE CLAMPS
CF-C
 Page 13 - 6

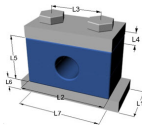
HEAVY DUTY CLAMPS

HEAVY DUTY SINGLE
 TUBE CLAMPS
CP-C
 Page 13 - 7

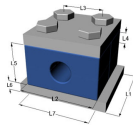

EXTRA HEAVY DUTY
 SINGLE TUBE CLAMPS
CP-D
 Page 13 - 8

SINGLE TUBE CLAMP COMPONENTS

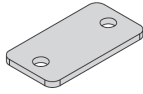
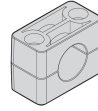
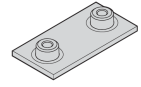
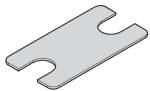
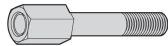
 HEX BOLT ZINC PLATED
CS-HB
 Page 13 - 8

 SINGLE CLAMP TOP
 PLATE
CS-TP
 Page 13 - 9

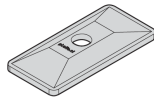
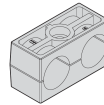
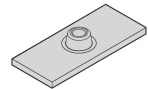
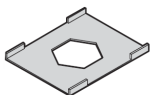
 SINGLE CLAMP JAWS
CS
 Page 13 - 10

 SINGLE CLAMP WELD
 PLATE
CS-BP
 Page 13 - 11

 SINGLE CLAMP LOCK
 TAB
CS-LT
 Page 13 - 11

 SINGLE CLAMP
 STACKING BOLT
CS-SB
 Page 13 - 12

TWIN TUBE CLAMP COMPONENTS

 HEX BOLT ZINC PLATED
CF-HB
 Page 13 - 12

 TWIN CLAMP TOP PLATE
CF-TP
 Page 13 - 13

 TWIN CLAMP JAWS
CF
 Page 13 - 14

 TWIN CLAMP WELD
 PLATE
CF-BP
 Page 13 - 15

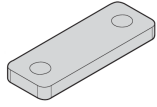
 TWIN CLAMP LOCK TAB
CF-LT
 Page 13 - 15

 TWIN CLAMP STACKING
 BOLT
CF-SB
 Page 13 - 15

HEAVY DUTY CLAMP COMPONENTS



HEX BOLT ZINC PLATED
CPS-HB
 Page 13 - 16

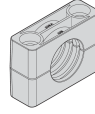

SINGLE CLAMP TOP
 PLATE
CPS-TP
 Page 13 - 16

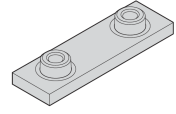

SINGLE CLAMP JAWS
 H/D
CPS
 Page 13 - 17



SINGLE CLAMP WELD
 PLATE
CPS-BP
 Page 13 - 17

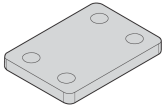

DOUBLE - SINGLE
 CLAMP TOP PLATE
CPD-TP
 Page 13 - 18

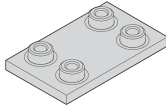

DOUBLE - SINGLE
 CLAMP WELD PLATE
CDP-BP
 Page 13 - 18

SINGLE TUBE CLAMPS
CS-C

SINGLE TUBE CLAMPS
 COMPLETE SINGLE CLAMPS WITH POLYPROPYLENE
 INSERTS

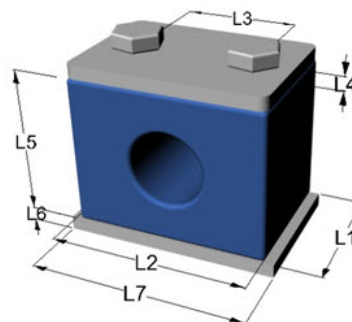

Part Number	Internal Bore - mm	Nominal Bore-Schedule Pipe	Internal Bore - imperial	L1 - mm	L2 - mm	L3 - mm	L4 - mm	L5 - mm	L6 - mm	L7 - mm	Hex bolt
CS1-M8C	8	-	5/16	30	28	N/A**	3	28	3	32	M6 x 30
CS2-04C	6.35	-	1/4	30	37	20	3	28	3	41	M6 x 30
CS2-06C	9.52	-	3/8	30	37	20	3	28	3	41	M6 x 30
CS2-08C	12.7	-	1/2	30	37	20	3	28	3	41	M6 x 30
CS2-M8C	8	-	5/16	30	37	20	3	28	3	41	M6 x 30
CS2-M10C	10	1/8	-	30	37	20	3	28	3	41	M6 x 30
CS2-M12C	12	-	-	30	37	20	3	28	3	41	M6 x 30
CS3-10C	16	-	5/8	30	43	26	3	33	3	47	M6 x 35
CS3-M14C	14	-	-	30	43	26	3	33	3	47	M6 x 35
CS3-M15C	15	-	-	30	43	26	3	33	3	47	M6 x 35
CS3-M18C	18	-	-	30	43	26	3	33	3	47	M6 x 35
CS4-12C	19	-	3/4	30	50	33	3	36	3	54	M6 x 40
CS4-16C	25.4	-	1	30	50	33	3	36	3	54	M6 x 40
CS4-M20C	20	-	-	30	50	33	3	36	3	54	M6 x 40
CS4-M22C	22	-	7/8	30	50	33	3	36	3	54	M6 x 40
CS5-20C	32	-	1.1/4	30	57	40	3	44	3	61	M6 x 45
CS5-H12C	26.9	3/4	-	30	57	40	3	44	3	61	M6 x 45
CS5-M28C	28	-	-	30	57	40	3	44	3	61	M6 x 45
CS5-M30C	30	-	-	30	57	40	3	44	3	61	M6 x 45
CS6-24C	38	-	1.1/2	30	70	52	3	57	3	73	M6 x 60
CS6-H16C	33.7	1	-	30	70	52	3	57	3	73	M6 x 60
CS6-H20C	42.4	1.1/4	-	30	70	52	3	57	3	73	M6 x 60
CS6-M35C	35	-	-	30	70	52	3	57	3	73	M6 x 60
CS6-M45C	45	-	-	30	70	52	3	57	3	73	M6 x 60
CS7-32C	50.8	-	2	30	86	66	3	66	3	88	M6 x 70
CS7-H28C	54	1.3/4	-	30	86	66	3	66	3	88	M6 x 70

DOUBLE TUBE CLAMPS
CF-C

DOUBLE TUBE CLAMPS
 COMPLETE DOUBLE CLAMPS W. POLYPROPYLENE
 INSERTS

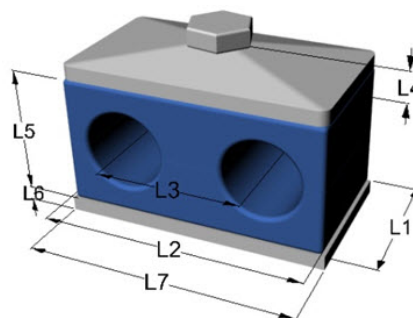

Part Number	Internal Bore - mm	Nominal Bore-Schedule Pipe	Internal Bore - imperial	L1 - mm	L2 - mm	L3 - mm	L4 - mm	L5 - mm	L6 - mm	L7 - mm	Hex bolt
CF1-04C	6.35	-	1/4	30	36	20	7	27	3	37	M6 x 35
CF1-06C	9.52	-	3/8	30	36	20	7	27	3	37	M6 x 35
CF1-08C	12.7	-	1/2	30	36	20	7	27	3	37	M6 x 35
CF1-M8C	8	-	5/16	30	36	20	7	27	3	37	M6 x 35
CF1-M10C	10	1/8	-	30	36	20	7	27	3	37	M6 x 35
CF1-M12C	12	-	-	30	36	20	7	27	3	37	M6 x 35
CF2-08C	12.7	-	1/2	30	54	29	7	27	3	55	M8 x 35
CF2-10C	16	-	5/8	30	54	29	7	27	3	55	M8 x 35
CF2-M14C	14	-	-	30	54	29	7	27	3	55	M8 x 35
CF2-M15C	15	-	-	30	54	29	7	27	3	55	M8 x 35
CF2-M18C	18	-	-	30	54	29	7	27	3	55	M8 x 35
CF3-12C	19	-	3/4	30	37	36	7	37	3	70	M8 x 45
CF3-16C	25.4	-	1	30	37	36	7	37	3	70	M8 x 45
CF3-M20C	20	-	-	30	37	36	7	37	3	70	M8 x 45
CF3-M22C	22	-	7/8	30	37	36	7	37	3	70	M8 x 45
CF4-M28C	28	-	-	30	81	45	7	42	3	85	M8 x 50
CF4-M30C	30	-	-	30	81	45	7	42	3	85	M8 x 50
CF5-20C	32	-	1.1/4	30	106	56	7	53	3	110	M8 x 65
CF5-24C	38	-	1.1/2	30	106	56	7	53	3	110	M8 x 65
CF5-M35C	35	-	-	30	106	56	7	53	3	110	M8 x 65
CF5-M42C	42	-	-	30	106	56	7	53	3	110	M8 x 65

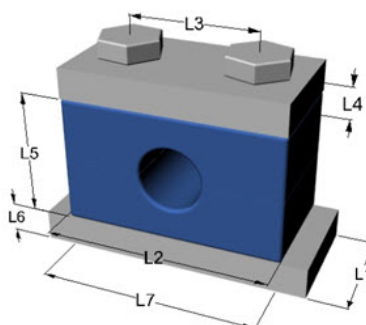
HEAVY DUTY CLAMPS
CP-C
**HEAVY DUTY SINGLE TUBE CLAMPS
 COMPLETE SINGLE CLAMPS W. POLYPROPYLENE INSERTS**

Part Number	Internal Bore - mm	Nominal Bore-Schedule Pipe	Internal Bore - imperial	L1 - mm	L2 - mm	L3 - mm	L4 - mm	L5 - mm	L6 - mm	L7 - mm	Hex bolt
CP1S-08C	12.7	-	1/2	30	57	33	8	33	8	70	M10 x 45
CP1S-10C	16	-	5/8	30	57	33	8	33	8	70	M10 x 45
CP2S-12C	19	-	3/4	30	69	45	8	49	8	87	M10 x 60
CP2S-16C	25.4	-	1	30	69	45	8	49	8	87	M10 x 60
CP2S-H08C	21.3	1/2	-	30	69	45	8	49	8	87	M10 x 60
CP2S-H12C	26.9	3/4	-	30	69	45	8	49	8	87	M10 x 60
CP3S-20C	32	-	1.1/4	30	84	60	8	60	8	105	M10 x 70
CP3S-24C	38	-	1.1/2	30	84	60	8	60	8	105	M10 x 70
CP3S-H16C	33.7	1	-	30	84	60	8	60	8	105	M10 x 70
CP3S-H20C	42.4	1.1/4	-	30	84	60	8	60	8	105	M10 x 70
CP4S-32C	50.8	-	2	45	117	91	10	88	10	140	M12 x 100
CP4S-H32C	60.3	2	-	45	117	91	10	88	10	140	M12 x 100

HEAVY DUTY CLAMPS

CP-D

EXTRA HEAVY DUTY SINGLE TUBE CLAMPS
 COMPLETE SINGLE CLAMPS W. POLYPROPYLENE INSERTS

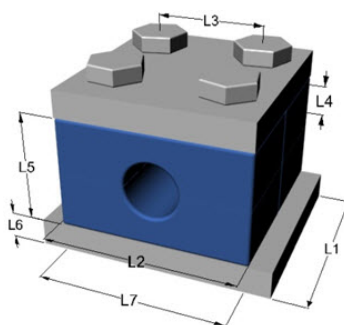

Part Number	Internal Bore - mm	Nominal Bore-Schedule Pipe	Internal Bore - imperial	L1 - mm	L2 - mm	L3 - mm	L4 - mm	L5 - mm	L6 - mm	L7 - mm	Hex bolt
CP2D-12C	19	-	3/4	60	69	45	8	49	8	87	M10 x 60
CP2D-16C	25.4	-	1	60	69	45	8	49	8	87	M10 x 60
CP3D-20C	32	-	1.1/4	60	84	60	8	60	8	105	M10 x 70
CP3D-24C	38	-	1.1/2	60	84	60	8	60	8	105	M10 x 70
CP4D-32C	50.8	-	2	90	117	91	10	88	10	140	M12 x 100

SINGLE TUBE CLAMP COMPONENTS

CS-HB

HEX BOLT ZINC PLATED
 HEX BOLT ZINC PLATED



Part Number	Group	Size	Style
CS1/2-HB	1-2	M6 x 30	Single clamp
CS3-HB	3	M6 x 35	Single clamp
CS4-HB	4	M6 x 40	Single clamp
CS5-HB	5	M6 x 45	Single clamp
CS6-HB	6	M6 x 60	Single clamp
CS7-HB	7	M6 x 70	Single clamp

SINGLE TUBE CLAMP COMPONENTS
CS-TP

SINGLE CLAMP TOP PLATE

SINGLE CLAMP TOP PLATE LIGHT DUTY

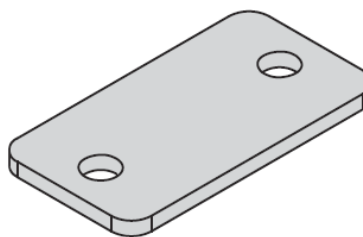

Part Number	Group	Style
CS1-TP	1	Single clamp
CS2-TP	2	Single clamp
CS3-TP	3	Single clamp
CS4-TP	4	Single clamp
CS5-TP	5	Single clamp
CS6-TP	6	Single clamp
CS7-TP	7	Single clamp

SINGLE TUBE CLAMP COMPONENTS
CS

SINGLE CLAMP JAWS

SINGLE CLAMP JAWS LIGHT DUTY

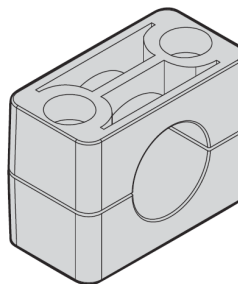

Part Number	Group	Size	Style
CS1-M8	1	8	Single clamp
CS2-04	2	1/4	Single clamp
CS2-06	2	3/8	Single clamp
CS2-08	2	1/2	Single clamp
CS2-M10	2	10	Single clamp
CS2-M12	2	12	Single clamp
CS2-M8	2	8	Single clamp
CS3-M14	3	14	Single clamp
CS3-M15	3	15	Single clamp
CS3-M16	3	16	Single clamp
CS3-M18	3	18	Single clamp
CS4-12	4	3/4	Single clamp
CS4-16	4	1	Single clamp
CS4-M20	4	20	Single clamp
CS4-M22	4	22	Single clamp
CS5-20	5	1.25	Single clamp
CS5-H12	5	26.9mm	Single clamp
CS5-M28	5	28	Single clamp
CS5-M30	5	30	Single clamp
CS6-H16	6	33.7	Single clamp
CS6-M35	6	35	Single clamp
CS6-M38	6	38	Single clamp
CS6-M42	6	42	Single clamp
CS6-M45	6	45	Single clamp
CS7-32	7	2	Single clamp
CS7-H24	7	48.3	Single clamp
CS7-H28	7	54	Single clamp

SINGLE TUBE CLAMP COMPONENTS
CS-BP

SINGLE CLAMP WELD PLATE
 SINGLE CLAMP WELD PLATE LIGHT DUTY

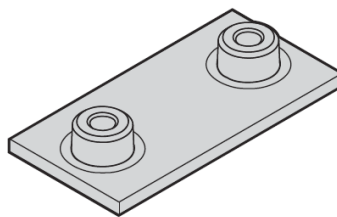

Part Number	Group	Style
CS1-BP	1	Single clamp
CS2-BP	2	Single clamp
CS3-BP	3	Single clamp
CS4-BP	4	Single clamp
CS5-BP	5	Single clamp
CS6-BP	6	Single clamp
CS7-BP	7	Single clamp

SINGLE TUBE CLAMP COMPONENTS
CS-LT

SINGLE CLAMP LOCK TAB
 SINGLE CLAMP LOCK TAB FOR STACKING BOLT

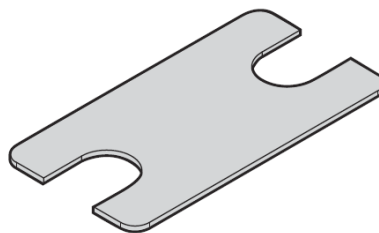

Part Number	Group	Style
CS2-LT	2	Single clamp
CS3-LT	3	Single clamp
CS4-LT	4	Single clamp
CS5-LT	5	Single clamp
CS6-LT	6	Single clamp

SINGLE TUBE CLAMP COMPONENTS

CS-SB

SINGLE CLAMP STACKING BOLT
 SINGLE CLAMP STACKING BOLT LIGHT DUTY

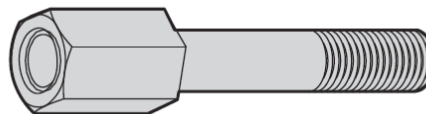

Part Number	Group	Style
CS2-SB	2	Single clamp
CS3-SB	3	Single clamp
CS4-SB	4	Single clamp
CS5-SB	5	Single clamp
CS6-SB	6	Single clamp

TWIN TUBE CLAMP COMPONENTS

CF-HB

HEX BOLT ZINC PLATED
 HEX BOLT ZINC PLATED



Part Number	Group	Size	Style
CF1-HB	1	M6 x 35	Double clamp
CF2-HB	2	M8 x 35	Double clamp
CF3-HB	3	M8 x 45	Double clamp
CF4-HB	4	M8 x 50	Double clamp
CF5-HB	5	M8 x 60	Double clamp

TWIN TUBE CLAMP COMPONENTS
CF-TP

TWIN CLAMP TOP PLATE

TWIN CLAMP TOP PLATE LIGHT DUTY

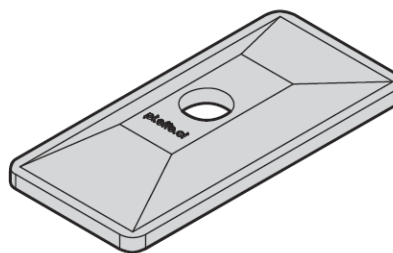

Part Number	Group	Style
CF1-TP	1	Double clamp
CF2-TP	2	Double clamp
CF3-TP	3	Double clamp
CF4-TP	4	Double clamp
CF5-TP	5	Double clamp

TWIN TUBE CLAMP COMPONENTS
CF

TWIN CLAMP JAWS

TWIN CLAMP JAWS LIGHT DUTY

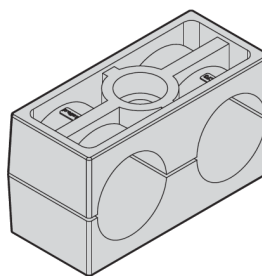

Part Number	Group	Size	Style
CF1-04	1	1/4	double clamp
CF1-06	1	3/8	double clamp
CF1-08	1	1/2	double clamp
CF1-M10	1	10	Double clamp
CF1-M12	1	12	Double clamp
CF1-M8	1	8	Double clamp
CF2-08	2	1/2	Double clamp
CF2-M14	2	14	Double clamp
CF2-M15	2	15	Double clamp
CF2-M16	2	16	Double clamp
CF2-M18	2	18	Double clamp
CF3-12	3	3/4	Double clamp
CF3-M20	3	20	Double clamp
CF3-M22	3	22	Double clamp
CF3-M25	3	25	Double clamp
CF4-M28	4	28	Double clamp
CF4-M30	4	30	Double clamp
CF5-20	5	1 1/4	Double clamp
CF5-M35	5	35	Double clamp
CF5-M38	5	38	Double clamp
CF5-M42	5	42	Double clamp

TWIN TUBE CLAMP COMPONENTS
CF-BP

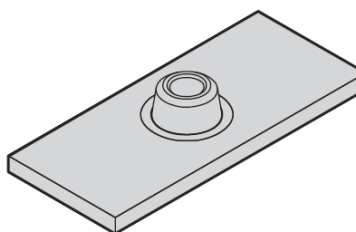
 TWIN CLAMP WELD PLATE
 TWIN CLAMP WELD PLATE LIGHT DUTY

Part Number	Group	Style
CF1-BP	1	Double clamp
CF2-BP	2	Double clamp
CF3-BP	3	Double clamp
CF4-BP	4	Double clamp
CF5-BP	5	Double clamp

TWIN TUBE CLAMP COMPONENTS
CF-LT

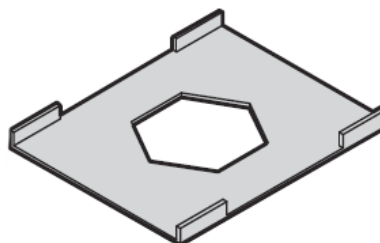
 TWIN CLAMP LOCK TAB
 TWIN CLAMP LOCK TAB FOR STACKING BOLT

Part Number	Group	Style
CF1-LT	1	Double clamp
CF-LT	2-5	Double clamp

TWIN TUBE CLAMP COMPONENTS
CF-SB

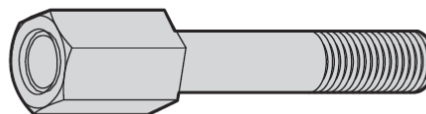
 TWIN CLAMP STACKING BOLT
 TWIN CLAMP STACKING BOLT LIGHT DUTY

Part Number	Group	Style
CF1-SB	1	Double clamp
CF2-SB	2	Double clamp
CF3-SB	3	Double clamp
CF4-SB	4	Double clamp
CF5-SB	5	Double clamp

HEAVY DUTY CLAMP COMPONENTS

CPS-HB

HEX BOLT ZINC PLATED
 HEX BOLT ZINC PLATED



Part Number	Group	Size	Style
CP1S-HB	1	M10 x 45	Heavy single
CP2S-HB	2	M10 x 60	Heavy single
CP3S-HB	3	M10 x 70	Heavy single
CP4S-HB	4	M12 x 100	Heavy single

HEAVY DUTY CLAMP COMPONENTS

CPS-TP

SINGLE CLAMP TOP PLATE
 SINGLE CLAMP TOP PLATE HEAVY DUTY

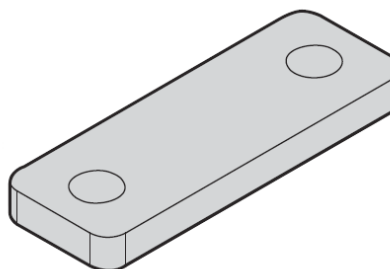

Part Number	Group	Style
CP1S-TP	1	Heavy single
CP2S-TP	2	Heavy single
CP3S-TP	3	Heavy single
CP4S-TP	4	Heavy single

HEAVY DUTY CLAMP COMPONENTS
CPS

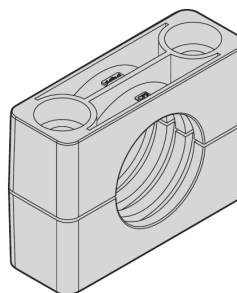
 SINGLE CLAMP JAWS H/D
 SINGLE CLAMP JAWS HEAVY DUTY

Part Number	Group	Size	Style
CP1S-08	1	1/2	Heavy single
CP1S-M16	1	5/8	Heavy single
CP2S-12	2	3/4	Heavy single
CP2S-16	2	1	Heavy single
CP2S-H08	2	21.3	Heavy single
CP2S-H12	2	26.9	Heavy single
CP3S-H16	3	33.7	Heavy single
CP3S-H20	3	42.4	Heavy single
CP3S-M32	3	32	Heavy single
CP3S-M38	3	38	Heavy single
CP4S-32	4	2	Heavy single
CP4S-H32	4	60.3	Heavy single

HEAVY DUTY CLAMP COMPONENTS
CPS-BP

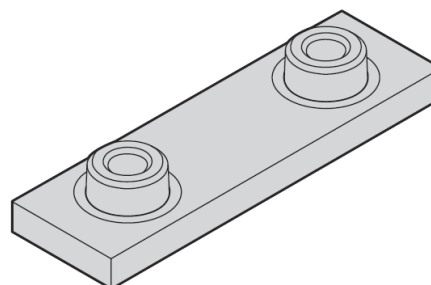
 SINGLE CLAMP WELD PLATE
 SINGLE CLAMP WELD PLATE HEAVY DUTY

Part Number	Group	Style
CP1S-BP	1	Heavy single
CP2S-BP	2	Heavy single
CP3S-BP	3	Heavy single
CP4S-BP	4	Heavy single

HEAVY DUTY CLAMP COMPONENTS

CPD-TP

DOUBLE - SINGLE CLAMP TOP PLATE
 DOUBLE SINGLE CLAMP TOP PLATE HEAVY DUTY

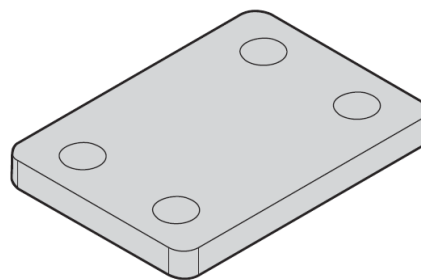

Part Number	Group	Style
CP2D-TP	2	Heavy double
CP3D-TP	3	Heavy double
CP4D-TP	4	Heavy double

HEAVY DUTY CLAMP COMPONENTS

CDP-BP

DOUBLE - SINGLE CLAMP WELD PLATE
 DOUBLE SINGLE CLAMP WELD PLATE HEAVY DUTY

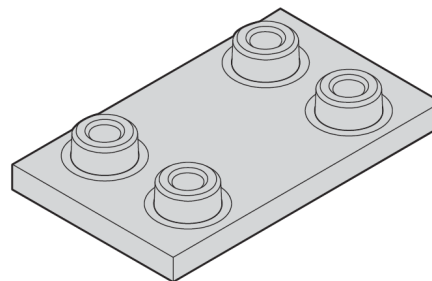

Part Number	Group	Style
CP2D-BP	2	Heavy double
CP3D-BP	3	Heavy double
CP4D-BP	4	Heavy double